



J01370

Console Washer

2013-11-01

GENERAL

Kit Numbers

94753-99

Models

For model fitment information, see the P&A retail catalog or the Parts and Accessories section of www.harley-davidson.com (English only).

Kit Contents

Table 1. Kit Contents

DESCRIPTION	PART NUMBER
Console washer	Not sold
Screw, 3/4 in., used on FLHR only	Not sold
Screw, 1 in., used on Softail only	Not sold
Bar and Shield hole plug	94754-99

NOTE

All Service Parts available for this kit are listed above.

INSTALLATION

1994 and later Road King Models

1. See [Figure 1](#). Remove the stock washer and bolt from the location shown. Discard hardware.
2. Install new console washer with 3/4 inch screw as shown.
3. Snap bar and shield hole plug into place over screw head.

1984 and later Softail Models

1. See [Figure 2](#). Remove the stock washer and bolt from the location shown. Discard hardware.
2. Install new console washer with 1 inch screw as shown.
3. Snap bar and shield hole plug into place over screw head.

is08112

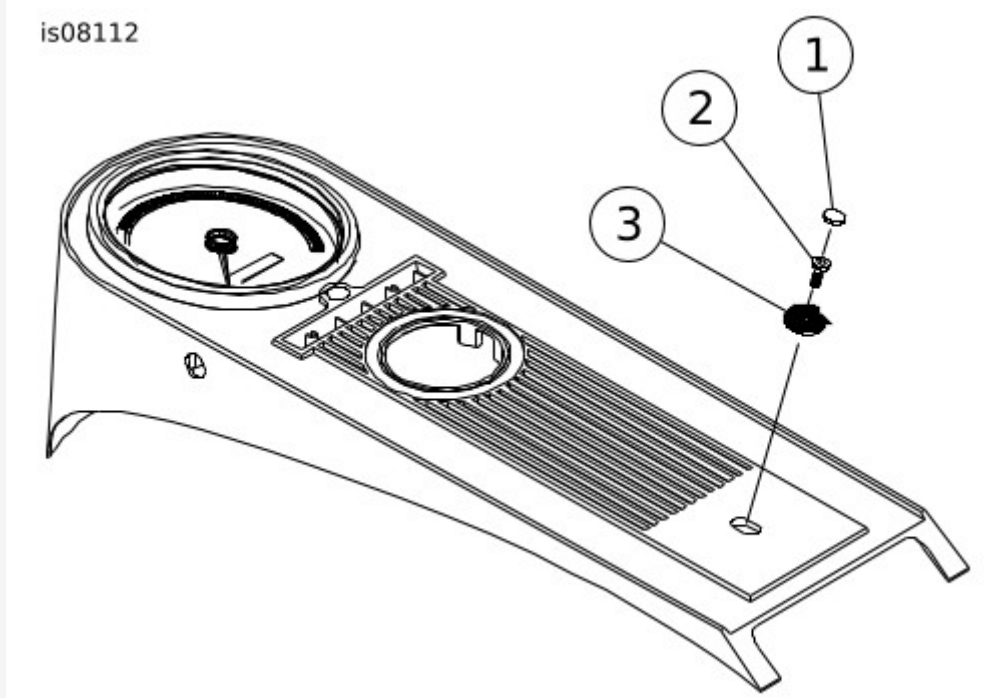

[VIEW INTERACTIVE IMAGE](#)

1. Bar and shield hole plug.
2. 3/4 in. screw.
3. Console washer.

Figure 1. Installation on FLHR Instrument Panel

is08113

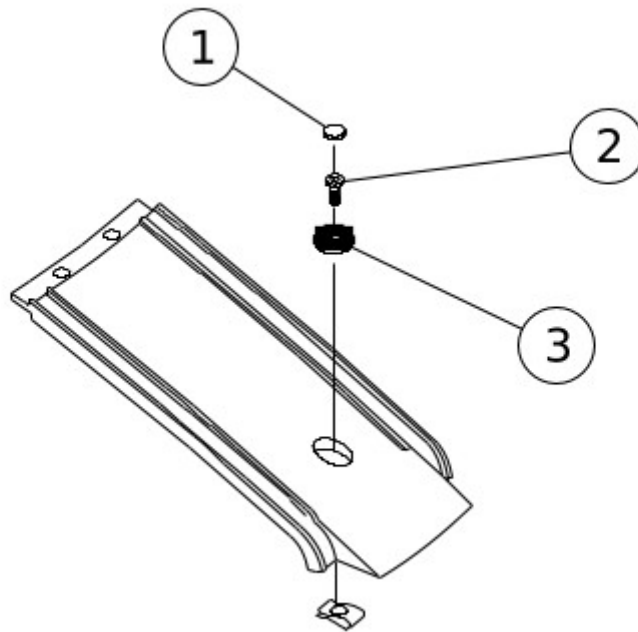

[VIEW INTERACTIVE IMAGE](#)

1. Bar and shield hole plug.
2. 1 in. screw.
3. Console washer.

Figure 2. Installation on Softail Tank Panel